

1	2		3	4	5	6	7	8	
A	A	B	B	C	C	D	D	E	E
JOB-NO.:	PROJECT-NO.:	SKETCH:	CUST.:	SIMILAR:	MACH.NO.:	STATION:	SPINDLE:	PART-NAME.:	PART NO.:
MATERIAL:	OP-NO.:	TOOL-NO.:	HOLE-NO.:	BALANCING GRADE DIN ISO 1940-G (COMPLETE ASSEMBLY) AT R.P.M. -1	ADDITIONALLY TO VA-NO: 07.05.01 MARK WITH	DIMENSIONAL TOLERANCES PER ISO 2768-F UNLESS OTHERWISE SPECIFIED	DIMENSIONS NOT SHOWN ARE MAPAL STANDARD	REGISTERED WITH GERMAN AND FOREIGN PATENT OFFICES	TITLE: BALL AND TORIC MILLING CUTTER, END MILLING CUTTER, INDEXABLE
C	D	E	F	-	-	-	-	-	-
C	D	E	F	-	-	-	-	-	-
C	D	E	F	1	-	1	PC	31161844	TORX-SCREW
C	D	E	F	PART	TYP	QUAN.	UT	MATERIAL NUMBER	DESCRIPTION
C	D	E	F	TECHNICAL SPECIFICATION	CUSTOMER NUMBER	DATE	NAME	DRAWN	28.04.2020
C	D	E	F	G.MONTINI	APP.	CHK.	SCALE: 1:1	FORMAT: A3	INDEX
C	D	E	F	IMB001-008-092-HA12-Z2R-BM 08	31144119	607326822-000-00-EN1	00	REPLACES DWG. NO.:	REPLACED BY DWG. NO.:
C	D	E	F	SHEET	V.	SHEETS	8	8	8

INDEX NO.	CHANGES	DATE	NAME
-	-	-	-
-	-	-	-
-	-	-	-
-	-	-	-
-	-	-	-

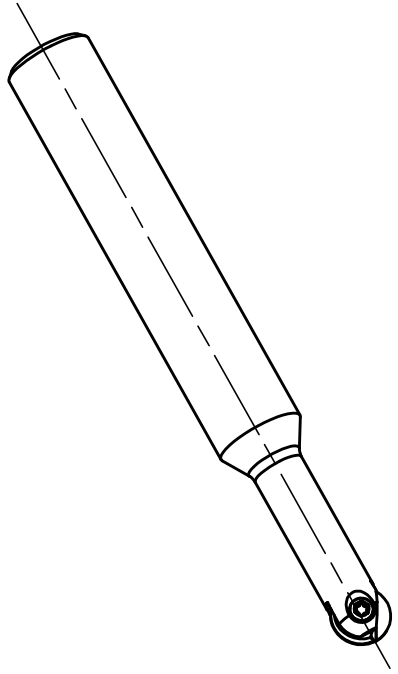

CYL-SHANK DIN 1835-A12

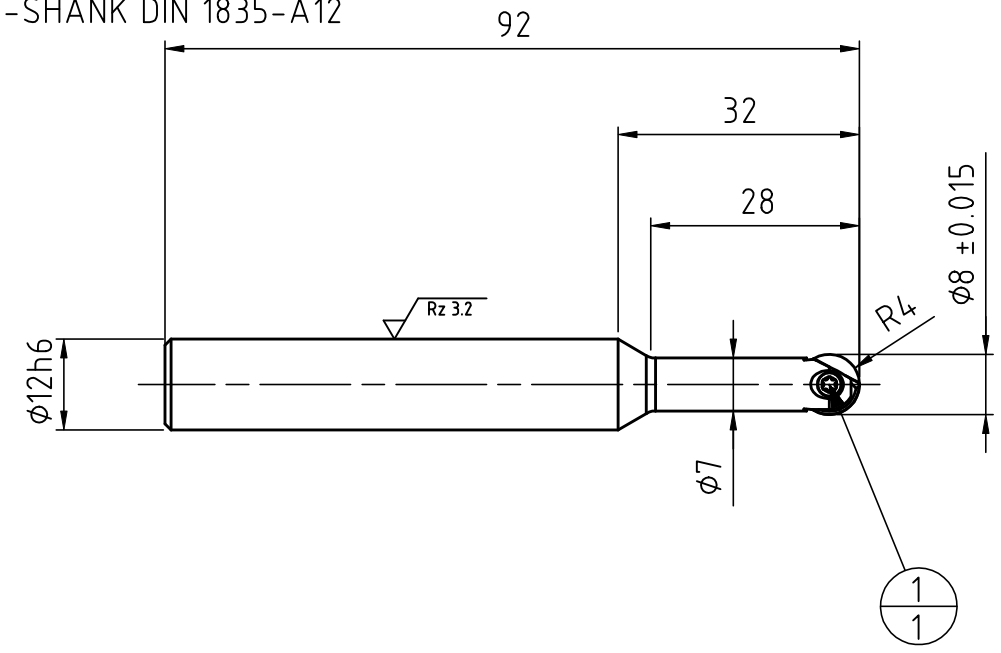

INSERT NOT INCLUDED

WEIGHT: 0,06Kg



MAPAL  
Präzisionswerkzeuge  
Dr. Kress KG